

D-Alu Suspension for KE-Interior System (KE-SRD)

DA-0009-US-02

Installation of T-SRD (top inlet)

The T-SRD is optional

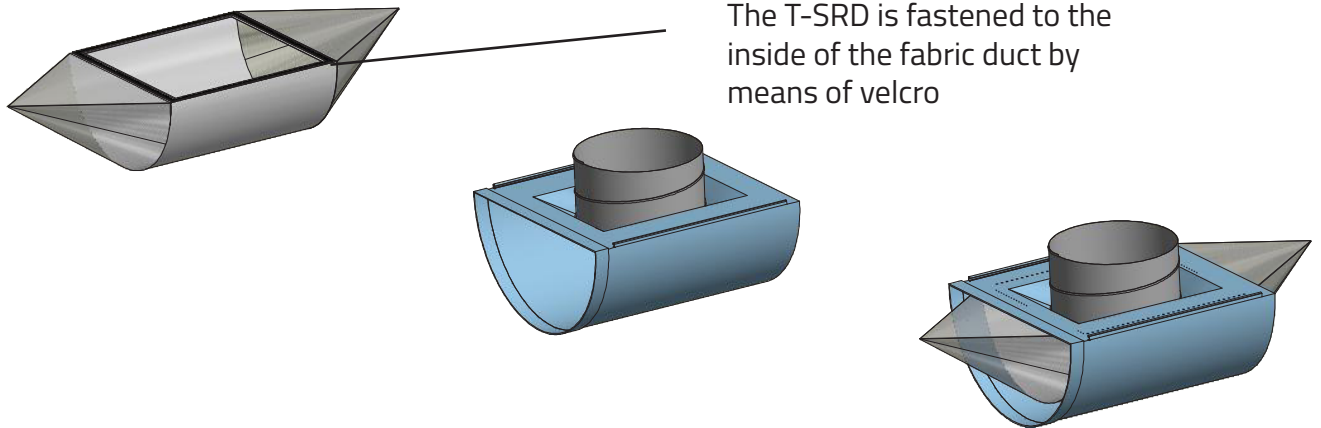

The T-SRD is fastened to the inside of the fabric duct by means of velcro

Installation of D-SRD (end inlet)

The D-SRD is optional

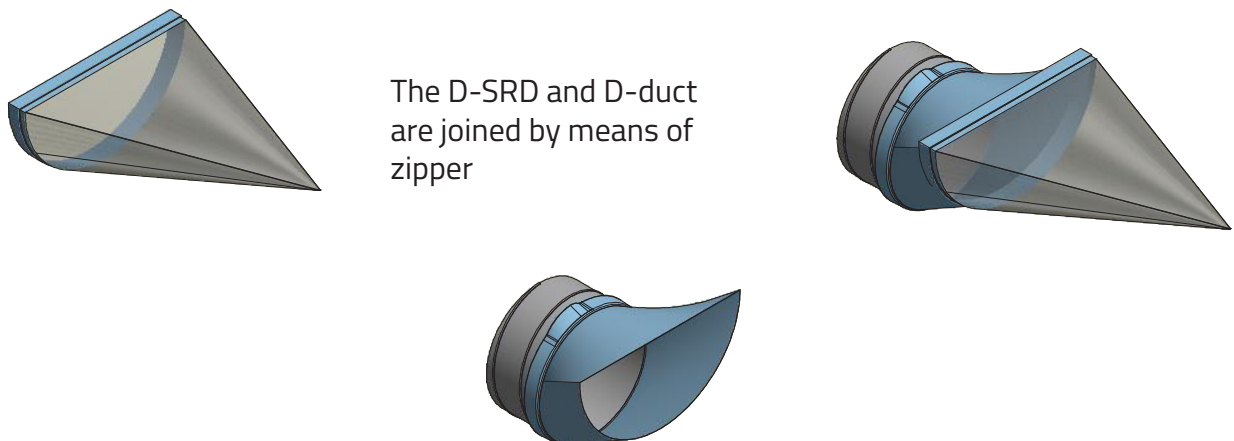

The D-SRD and D-duct are joined by means of zipper