

# Wire Suspension, Triple WO-0003-GB-00

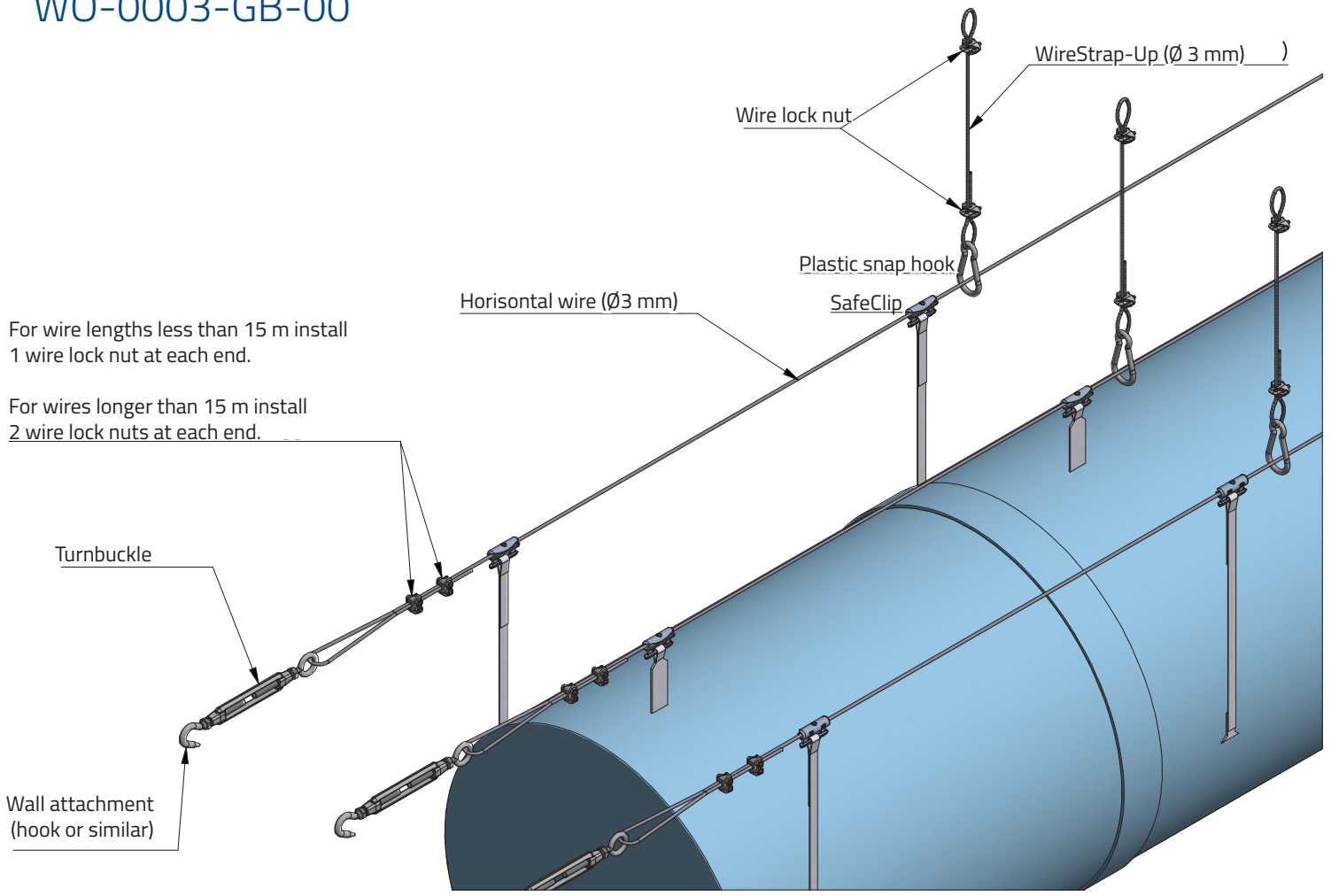

## Suspension types

- L. Smart-Adjust Strap-Up w/hook
- M. Smart-Adjust Strap-Up w/M6 thread
- N. Smart-Adjust Strap-Up w/zink plate
- O. Smart-Adjust Strap-Up w/M6 thread + nut
- R. Strap-Up with plastic snap hook
- S. Strap-Up with snap hook
- T. Plastic snap hook
- U. KE-Clip
- V. SafeClip
- X. Snap hook

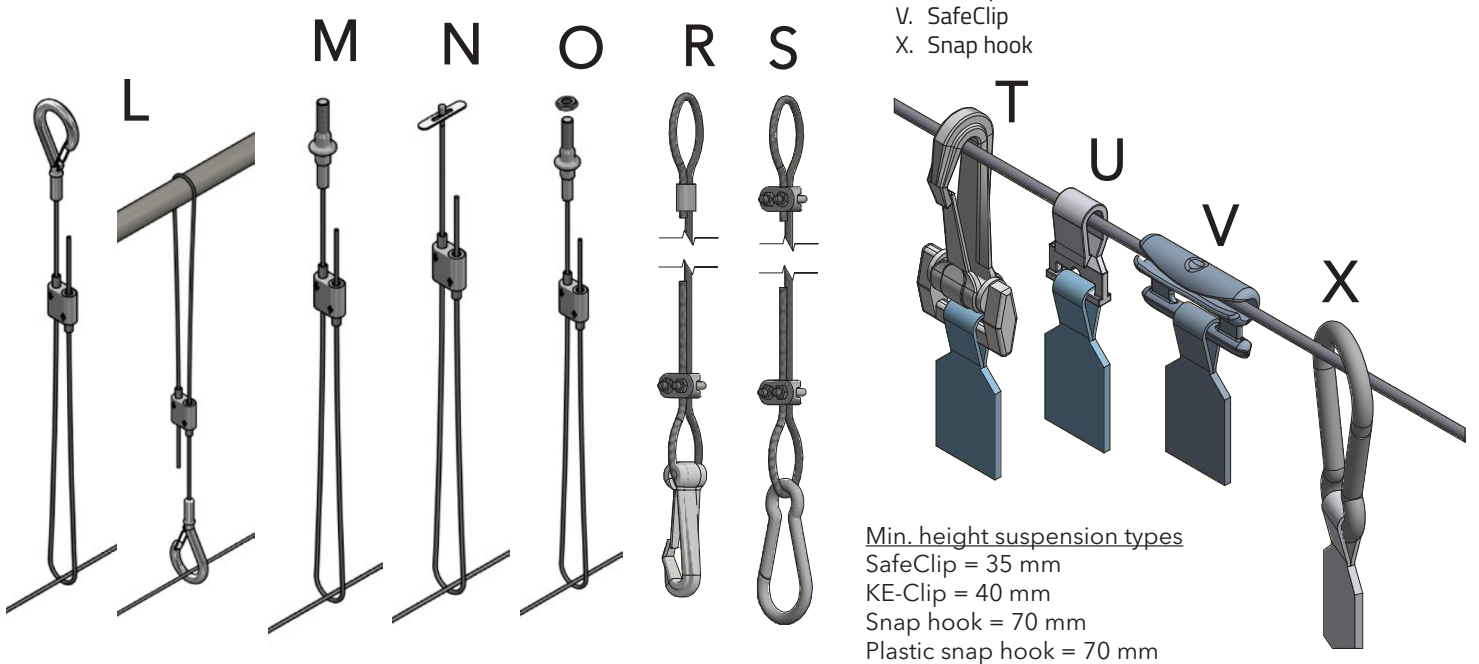

# Wire Suspension, Triple (Straight Duct)

WO-0004-GB-00

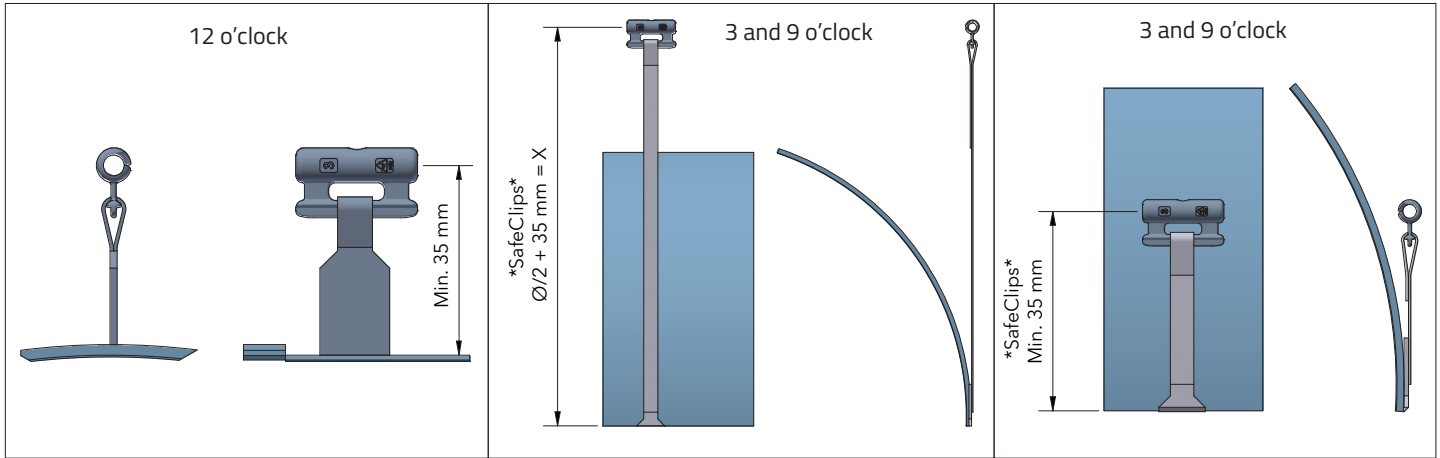

Mount horizontal wires. Apply tension of max. 20 kg and then tighten wire locknut. A turnbuckle turned from fully open to fully tensioned will shorten the wire by approx. 80 mm. For wires longer than 15 metres we recommend a turnbuckle at each end.

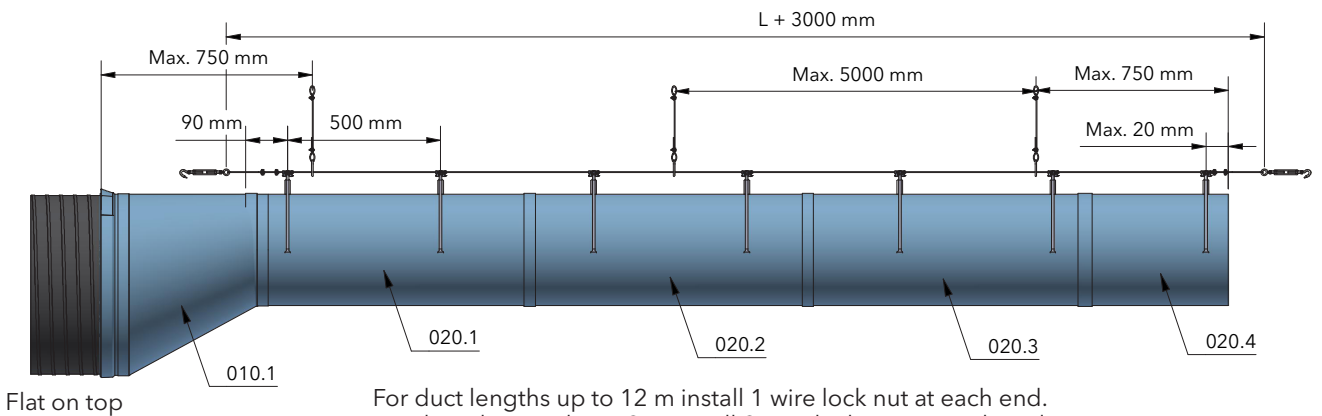
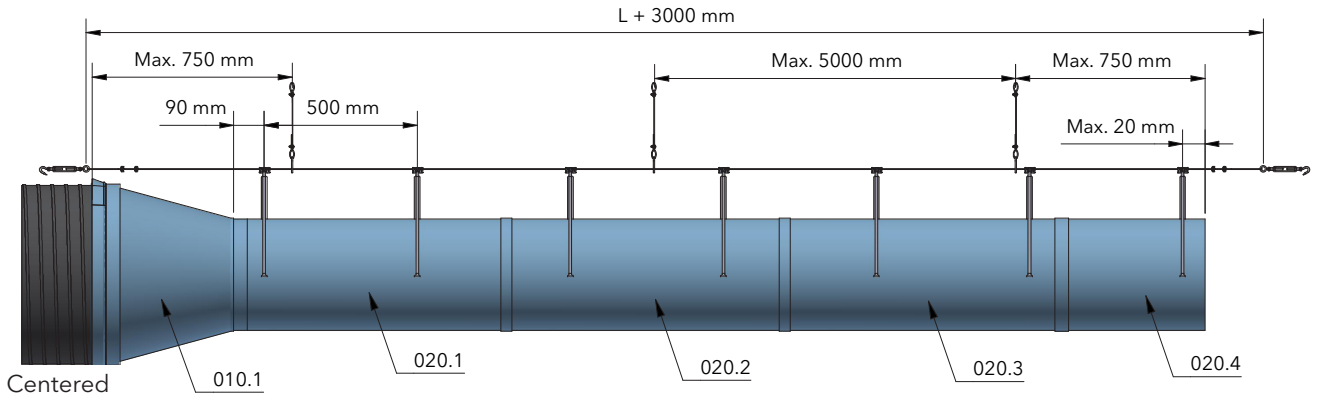

For duct lengths up to 12 m install 1 wire lock nut at each end.  
For ducts longer than 12 m install 2 wire lock nuts at each end.

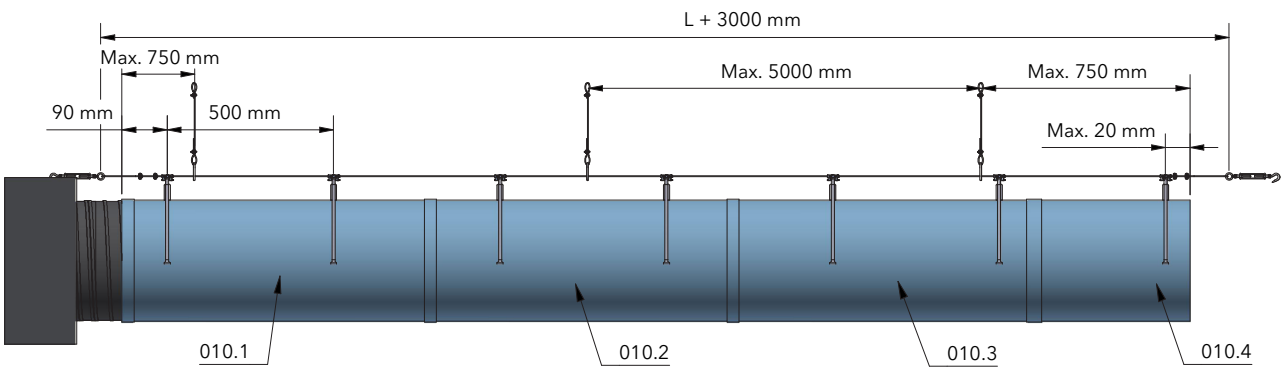

# Wire Suspension, Triple (Plenum)

WO-0005-GB-00

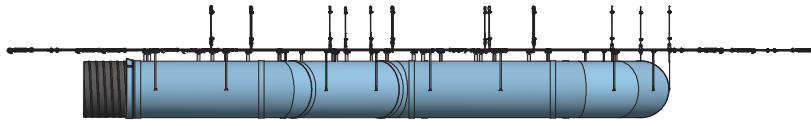

For ducts flat on top exceeding 500 mm diameter or with same diameter as the plenum, an additional clip is placed at the seam

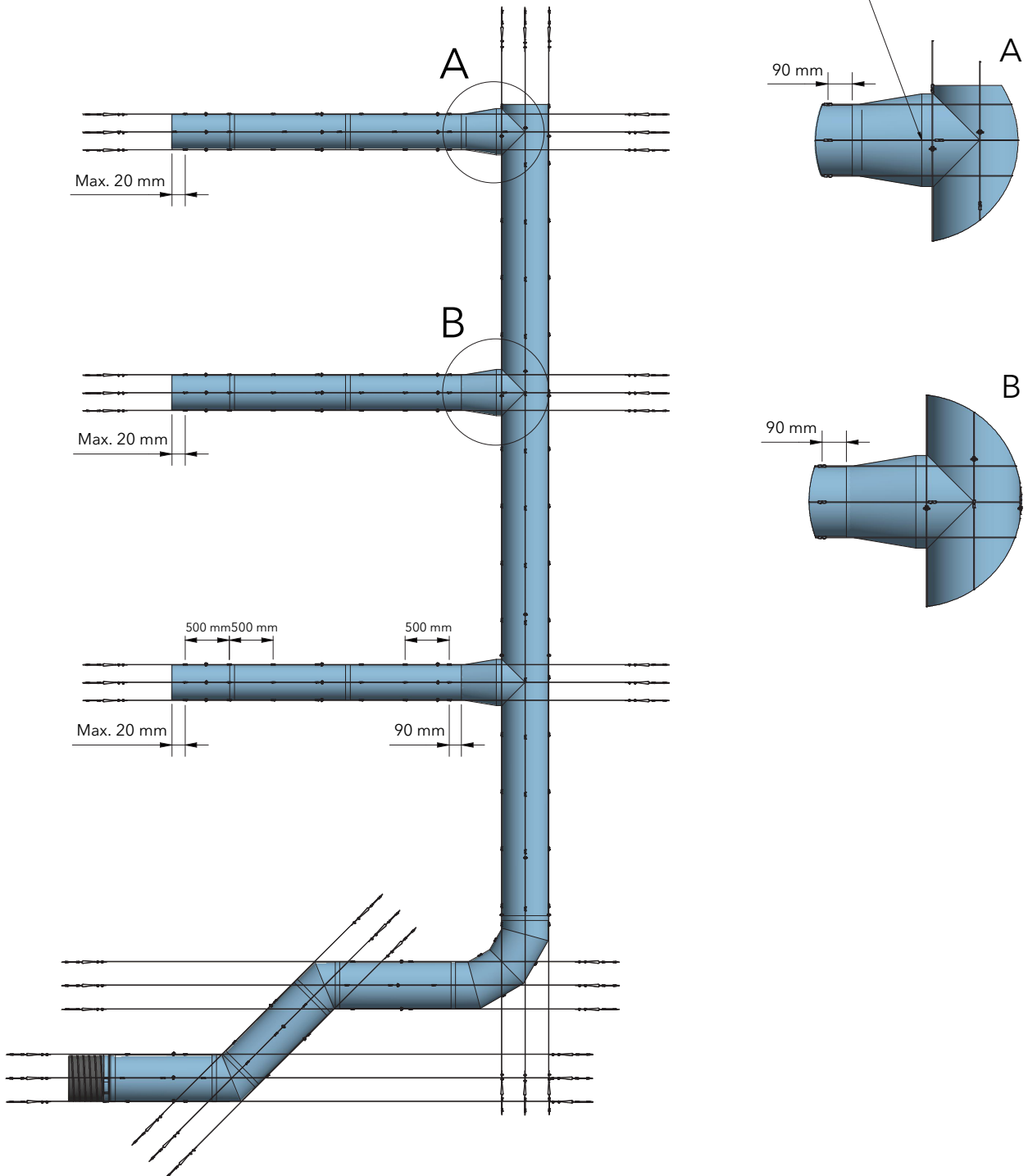

# Wire Suspension, Triple, KE-Elbow

WO-0012-GB-00

## Mitered elbow - see delivery note for specific angle

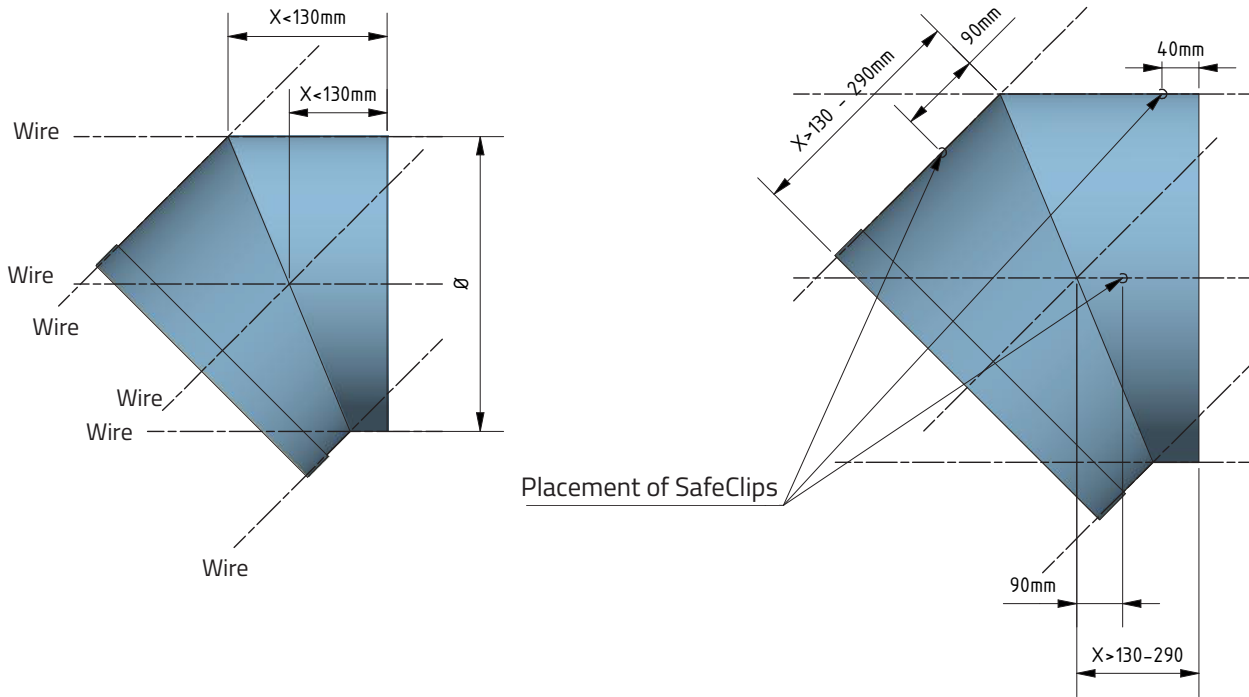

## Elbow 90°

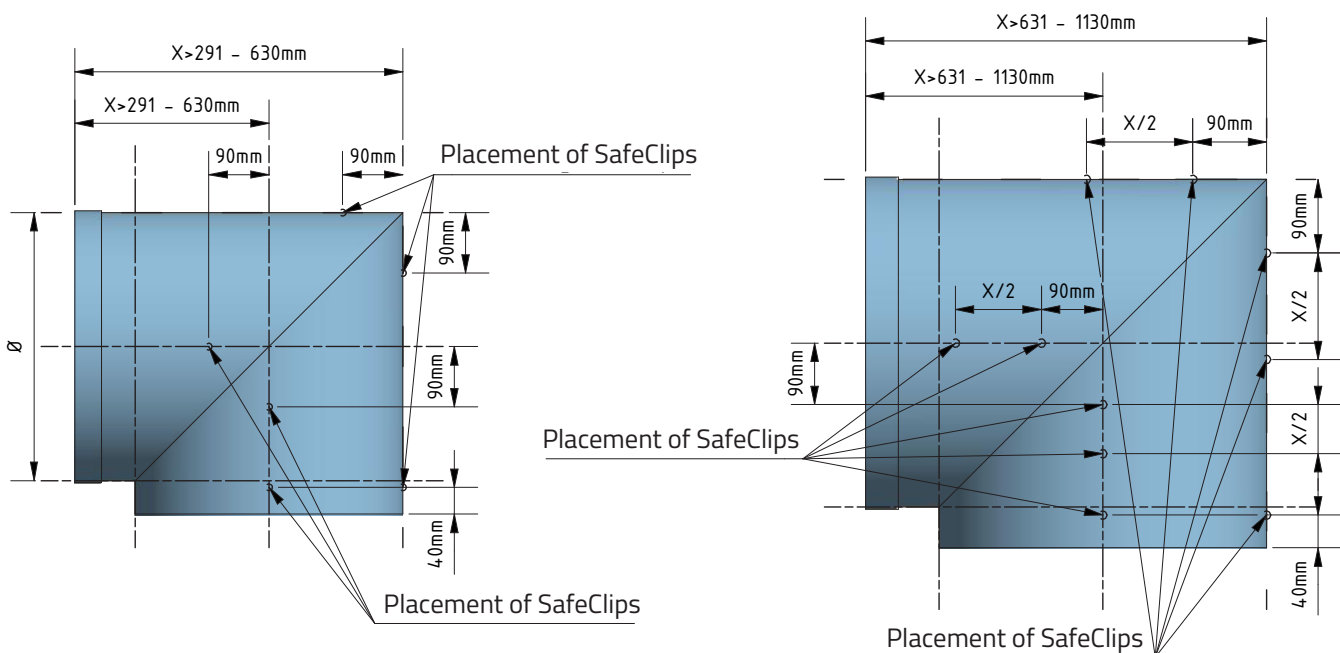

# Wire Suspension, Triple, KE-Bend

WO-0013-GB-00

## 45° bend

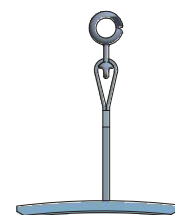
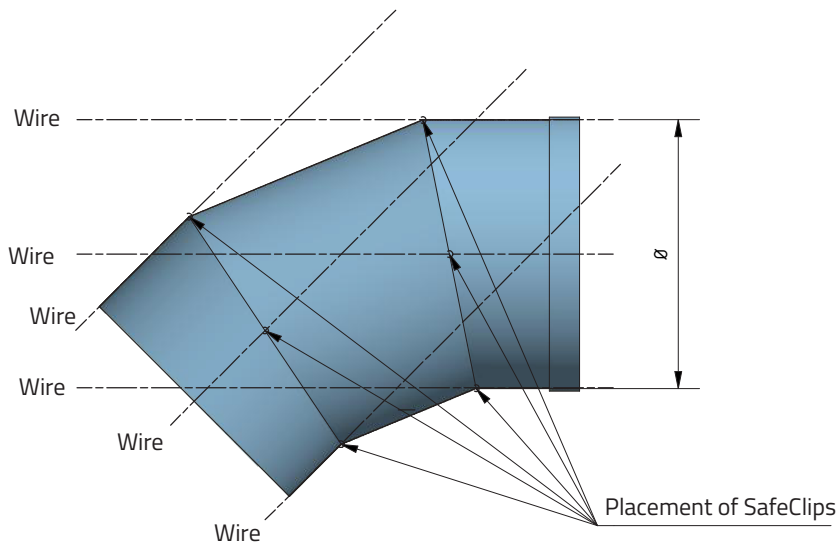

SafeClips  
Clip height min. 35 mm

Calculation:

$$\frac{\text{Ø}}{2} + \text{Clip height} = X \text{ mm}$$

Ex.:  $\frac{\text{Ø}400}{2} + 35 = 235 \text{ mm}$

Clips to be placed 40 mm from external zip.

## 90° bend

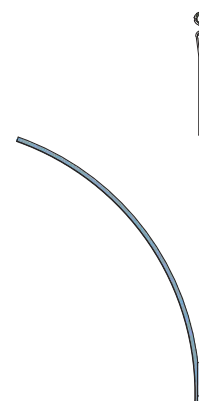
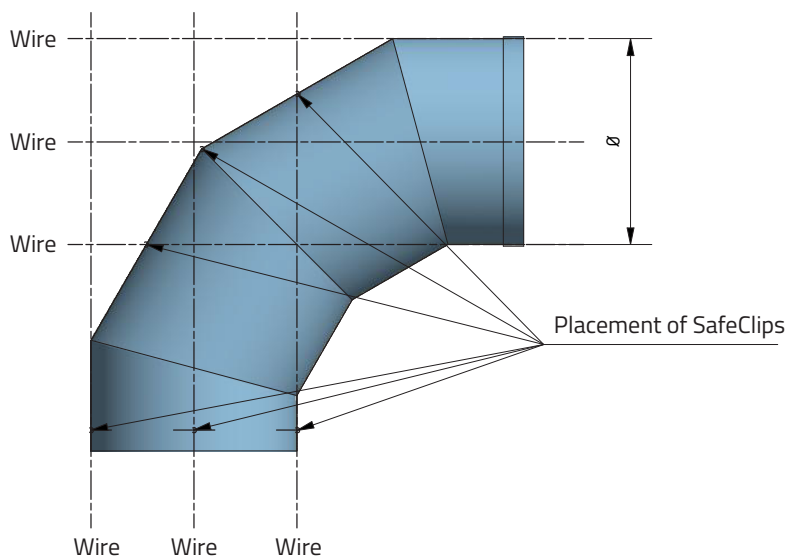

SafeClips  
Clip height min. 35 mm